



## GENERAL

PROJECT: MIDSHIP  
HULL MATERIAL: Steel  
SUPERSTRUCTURE: GRP  
VESSEL TYPE: Purse Seiner  
BUILDING YEAR: 2006

## DIMENSÕES PRINCIPAIS

COMPRIMENTO FORA A FORA: 19.00m  
COMPRIMENTO ENTRE PERPENDICULARES: 16.40m  
BOCA: 5.80m  
PONTAL: 2.90m

## DIMENSIONS

MAIN ENGINE: MTU 6DD, 450HP@1800 rpm  
GEAR BOX: Twin Disc MG 5114 DC - 4.17:1  
PROPULSION: FundiBronze

## SPEED

SPEED: 11.0 knots

## TANKS

FUEL: 24.00m<sup>3</sup>  
FRESH WATER: 3.75m<sup>3</sup>

## ENERGY

GEN SET: 2 x 120 KVA  
NETWORK: 400V/ 230V AC, 3 phase, 50Hz 24V DC

## ACCOMODATION

CREW: 12

## NAUTICAL AND COMMUNICATION

RADAR: Simrad RA 42  
ECHO SOUNDER: Simrad EQ44  
GPS PLOTTER: Simrad CX44  
AUTO PILOT: Simrad AP35  
SONAR: Suzuki S 1800  
RADIO VHF: 2 x Simrad RD68  
GMDSS: Sailor HC 4500B

## CARGO CAPACITY

FISH HOLD: 60m<sup>3</sup>

## FISHING EQUIPMENT

PURSE SEINER WINCH  
WINCH 1.2Ton

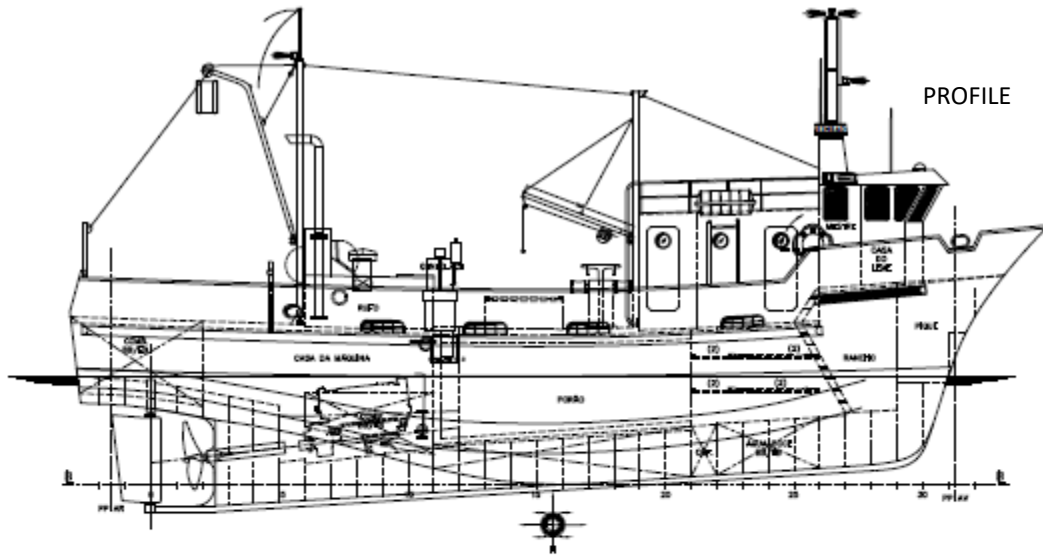

PROFILE

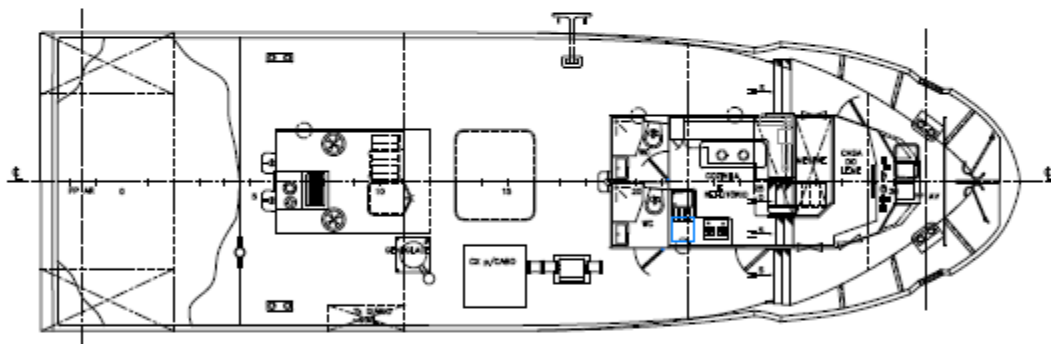

MAIN DECK

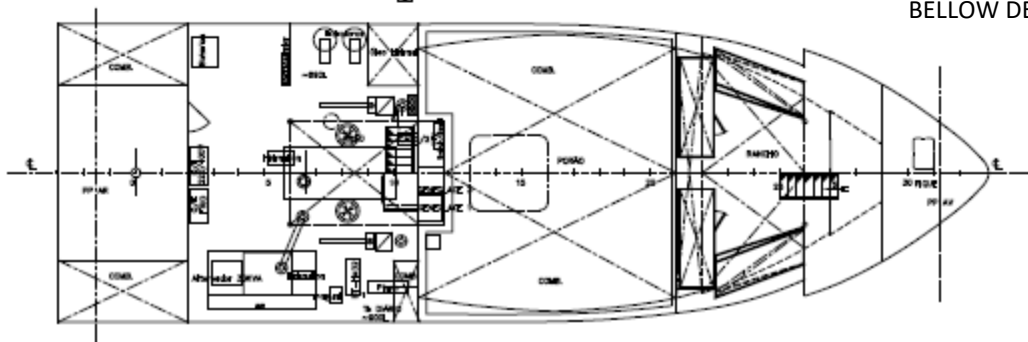

BELLOW DECK

Layout and equipment indicative.

Please contact [info@enp.pt](mailto:info@enp.pt) for more details.



**Estaleiros Navais de Peniche S.A.**

Molhe Leste  
2520-620 Peniche

Tel: +351 262 780 420

[www.enp.pt](http://www.enp.pt)

Portugal

[info@enp.pt](mailto:info@enp.pt)

39.353282, -9.36773