



## GENERAL

PROJECT: CARMARC DESIGN/ ENP  
HULL MATERIAL: GRP  
SUPERSTRUCTURE: GRP  
VESSEL TYPE: Pilot Boat  
BUILDING YEAR: 2012  
TYPE APPROVAL: DNV

## DIMENSIONS

LENGTH O.A.: 11.87m  
LENGH BPP: 9.72m  
BEAM: 4.15m  
DEPTH: 1.75m  
DWL: 0.8m

## PROPULSION

MAIN ENGINE: 2x Cummins QSB5.9 355HP@2800rpm  
GEAR BOX: 2x ZF 280-1 / 1.214:1  
WATERJET: Hamilton Jet - HJ292

## SPEED

SPEED: 25 knots

## TANKS

FUEL: 1,2m<sup>3</sup>  
FRESH WATER: 0,1m<sup>3</sup>

## ENERGY

NETWORK: 24V DC

## ACCOMODATION

CREW: 2  
PASSENGERS: 6

## NAUTICAL AND COMMUNICATION

RADAR/ CHART PLOTTER NAVNet3D: Furuno 1824C  
ECHO SOUNDER: Furuno LS-4100  
GPS: Furuno GP 320B  
MAGNETIC COMPASS  
RUDDER INDICATOR: vdo-hamilton  
WATERJET INDICATOR:vdo-hamilton  
RADIO VHF: 2 X Furuno FM-2721  
ANEMOMETER: Furuno FI-303-T

## SPECIFIC EQUIPMENT

“LIFE LINE” in Unirail

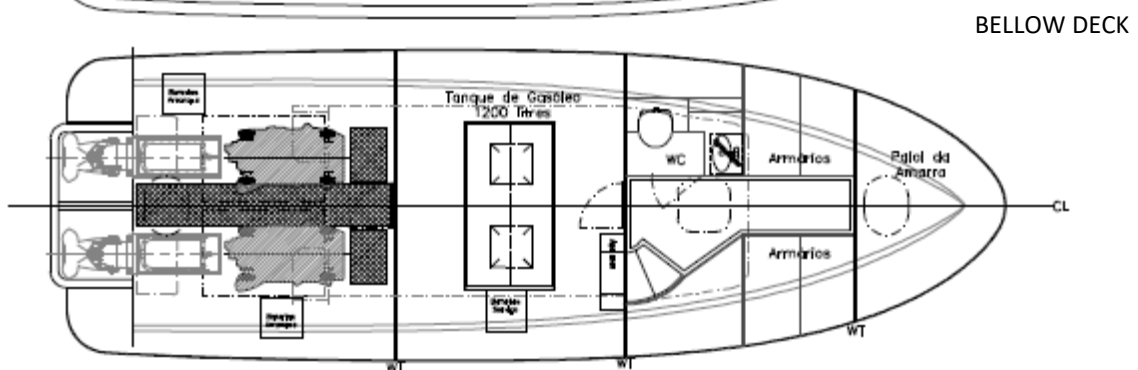
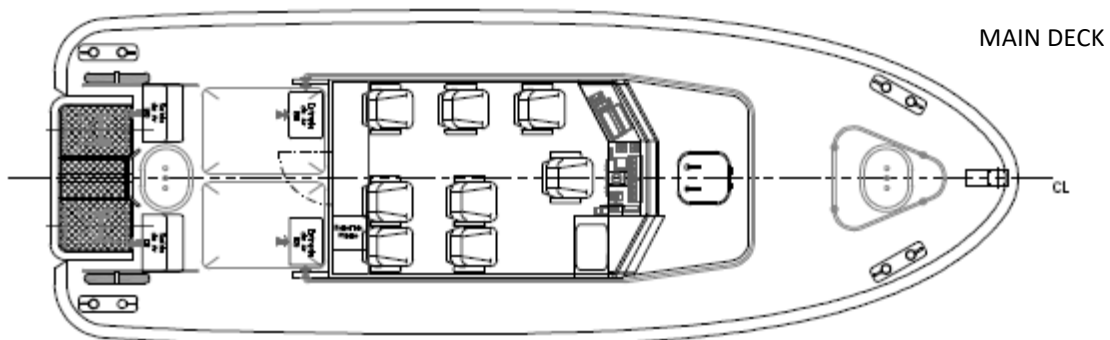
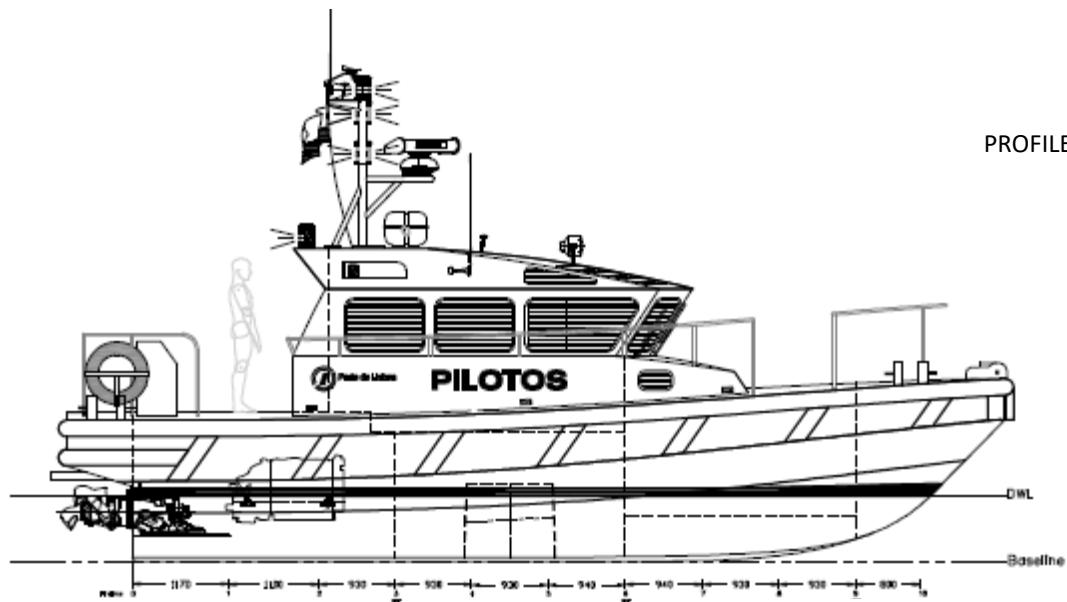

Layout and equipment indicative.

Please contact [info@enp.pt](mailto:info@enp.pt) for more details.



**Estaleiros Navais de Peniche S.A.**

Molhe Leste  
2520-620 Peniche

Tel: +351 262 780 420

[www.enp.pt](http://www.enp.pt)

Portugal

[info@enp.pt](mailto:info@enp.pt)

39.353282, -9.36773